



THE OFFICES  
AT ONE GALLE FACE

# WHERE ELEGANCE & BUSINESS INTERTWINE

---

Introducing Colombo's Premier Luxury  
Lifestyle Destination

ONE DEFINITIVE  
PLACE TO WORK,  
LIVE, PLAY & STAY

STAY  
SHANGRI-LA HOTEL

WORK  
THE OFFICES

PLAY  
THE MALL

LIVE  
THE RESIDENCES

## WORK THE OFFICES

Conduct business with ease from the heart of Colombo's golden district, with 600,000 sq.ft of premium office space and world class facilities.

.....

## LIVE THE RESIDENCES

Experience timeless living with 406 sophisticated residences across two towers and a full range of thoughtful amenities.

.....

## PLAY THE MALL

Enjoy over 250 exciting shopping, dining and entertainment options within The Mall's 7 extensive levels.

.....

## STAY SHANGRI-LA HOTEL

With over 500 rooms, 7 restaurants and fully equipped function spaces, indulge in the 5 star services and legendary hospitality offered by Shangri-La Hotel.







## OVERVIEW

One Galle Face is brought to you by Shangri-La, Asia Pacific's leading luxury hotel group. With over 95 hotels and resorts around the world, Shangri-La is regarded as one of the world's best hotel ownership and management companies. Comprising of four structures, The Mall, The Residences, Shangri-La Hotel Colombo and The Offices, One Galle Face combines both the service and hospitality of Shangri-La hotels with vibrant entertainment, elegant living and a premier office space.

The Offices at One Galle Face is an international grade business tower and beacon of economic growth. It will provide over 600,000 sq.ft of premium office space and world-class facilities in the heart of Colombo's commercial district. Fully integrated with extensive retail, dining and 5 star hotel amenities- The Offices at One Galle Face would provide its tenants the ultimate in convenience, connectivity and corporate profile.

## SOPHISTICATED OFFICE SPACE AND SPECTACULAR AMENITIES

Bask in the unmatched panoramic view of the Indian Ocean, Colombo City and Beira Lake, right from the comfort of your office. With the beautiful floor to ceiling glass perimeter windows, your office will be awash with natural light from its spectacular surroundings.

At the peak of convenience, your every need is accounted for at The Offices at One Galle Face. Never failing to impress, host dinners with clients at the ample distinguished restaurants present at The Mall and Shangri-La Hotel. Balance tranquility and work with first-rate spas and gyms at your fingertips. Well situated and carefully curated, claim any necessities at the luxury supermarkets, banks and pharmacies present on site. Let efficiency take hold when all your essentials are at your fingertips.

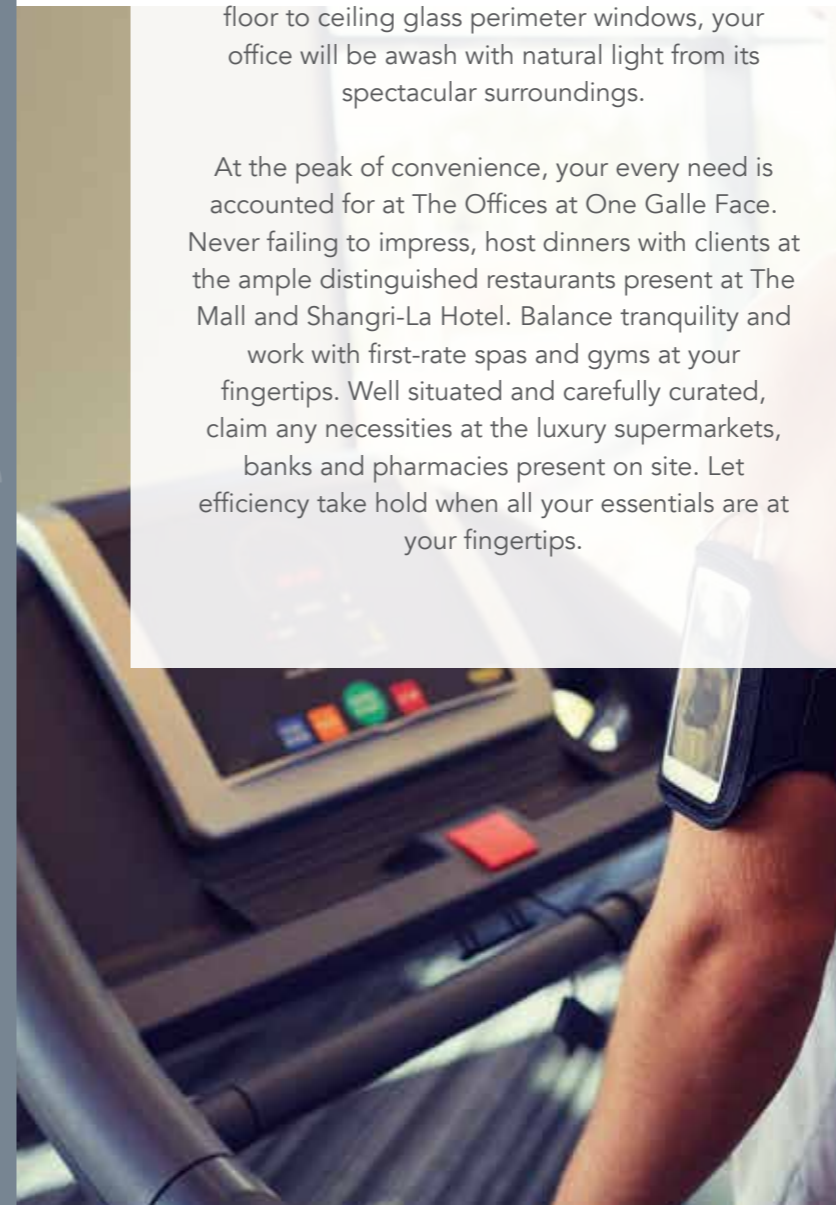
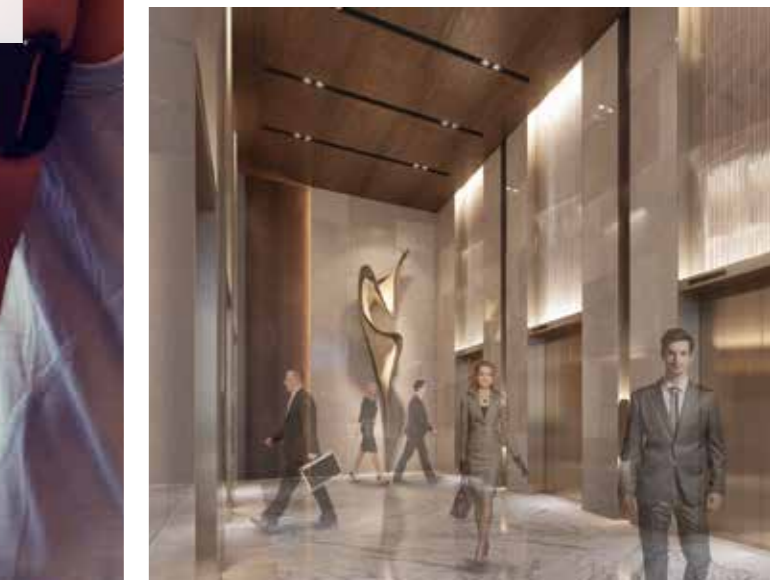



# THE MOST EXCLUSIVE BUSINESS COMMUNITY IN COLOMBO

## LOCATION

- \* Close proximity to the main public transport hubs
- \* Centrally located with easy access to key government institutions, hospitals, banks and hotels
- \* Faces the heart of Sri Lanka's urban recreational hot spot, the Galle Face Green – take a relaxing stroll, an outdoor jog or just unwind watching the setting sun

## EFFICIENCY

- \* Efficient 17,450 sq.ft of virtually column free floor space
- \* Rectangular floor plate and core design allowing efficient, modern and flexible office layout
- \* Interconnectivity between floors is facilitated through thoughtfully placed knockout panels

## INFRASTRUCTURE

- \* Fiber optic connectivity
- \* 100% back up power
- \* Fully integrated BMS systems
- \* High speed lifts
- \* Parking with a dedicated VIP drop off point
- \* International fire safety and security regulations in practice

## SUSTAINABILITY

- \* Double glazed, low e-coated perimeter window glass provides natural light whilst cutting out excessive solar radiation and saves energy
- \* Target to achieve "Singapore Green Mark – Gold Standard" by improving air quality, energy efficiency, support conservation efforts

Located in Colombo's premier luxury lifestyle destination and fully integrated with a contemporary collaboration of hotel, mall and residence.



**FLOORS:** 32 floors of office space starting from the 7th floor to the 38th floor



**THE OFFICES  
AT ONE GALLE FACE**

**HOTELS/RESIDENCES**

**KEY GOVERNMENT  
INSTITUTIONS & EMBASSIES**

- 1 Board of Investment (BOI)
- 2 Indian Embassy
- 3 Inland Revenue Department
- 4 British Embassy
- 5 Ceylon Electricity Board
- 6 Presidential Secretariat Office
- 7 USA Embassy

**BANKS**

- 1 Central Bank
- 2 Bank of Ceylon
- 3 Commercial Bank
- 4 Hatton National Bank
- 5 Sampath Bank
- 6 Standard Chartered Bank

**TRANSPORT**

- 1 Pettah Bus Stand

**MEDICAL FACILITIES & HOSPITALS**

- 1 Nawaloka Hospital

**TYPICAL FLOORPLAN**

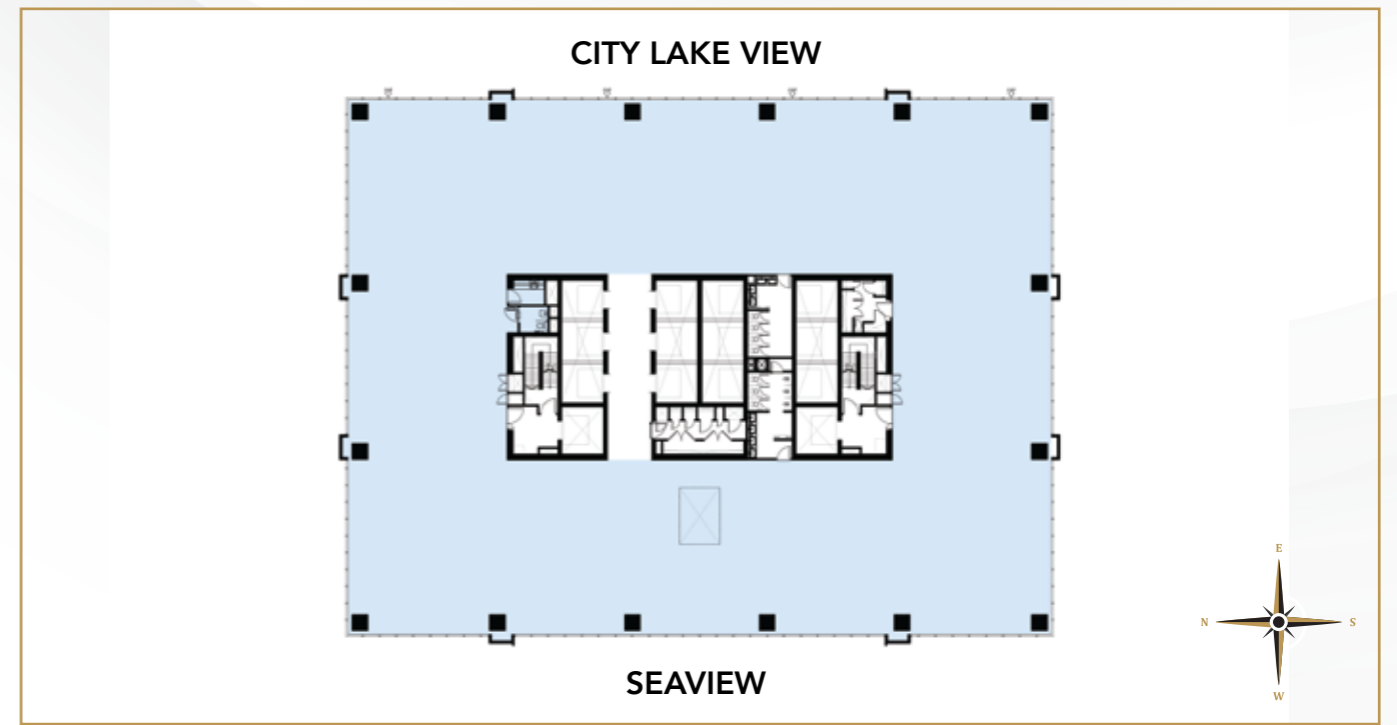

**PROJECT CONSULTANTS**

**DESIGN ARCHITECT**  
Mapsdesign Pte Ltd

**PROJECT ARCHITECT**  
DP Architects Pte Ltd

**LOCAL ARCHITECT**  
MICD Associates

**INTERIOR DESIGNER**  
BTR (HK) Ltd

**M&E CONSULTANT**  
TY Lin International Pte Ltd

**STRUCTURAL CONSULTANT**  
KK Lim & Associates Pte Ltd

**QUANTITY SURVEYOR**  
Davis Langdon KPK (Singapore) Pte Ltd

**SHINE AT THE HUB OF STYLE AND BRILLIANCE  
GET IN TOUCH WITH US TODAY**

**EMAIL:**  
INFO.OFFICES@ONEGALLEFACE.COM

**TELEPHONE:**  
+94 112 552 060 / +94 768 738 583

Reasonable care has been taken in the preparation of this brochure, but the developer and/or its agent(s) do not warrant the accuracy of the Marketing Materials and shall not be held responsible for any inaccuracies therein. The statements, information and depictions in the Marketing Materials are believed to be correct but shall not be relied upon as statements or representations of fact, and they are not intended to form any part of the contract for the leasing of retail units. In particular, visual representations such as pictures and drawings are artist's impression only, and are not representations of fact.



A PRESTIGIOUS PROJECT BY



**SHANGRI-LA**

**COLOMBO, SRI LANKA**